

# SLAT REPLACEMENT INSTRUCTIONS FOR DOOR MODELS 888 AND 889



This installation manual provides the trained door technician information required to replace the belts.  
**READ COMPLETE INSTRUCTIONS BEFORE PROCEEDING WITH REPAIR.**

Refer to the your Door Installation Instructions for additional safety warnings and precautions. Manual may also be used as a reference for any items that are not addressed by this document.  
Installation Manuals can be accessed at <https://www.Wayne-Dalton.com/Documents>.

**This manual is intended ONLY for professional use by a trained door systems technician.**

- Follow the standard work below when replacing slats. Failure to do so may result in severe or fatal injury.
- Refer to your Door Installation Instructions for additional safety warnings and precautions. Manual may also be used as a reference for any items that are not addressed by this document.

## **⚠ WARNING**

These Doors are large, heavy objects that move. Since moving objects can cause injuries, your safety and the safety of others depends on you reading the information in this manual. If you have any questions or do NOT understand the information presented, call technical support at 1-800-764-1457 (Option 2).

In this section and those that follow, the words "**DANGER**", "**WARNING**", and "**CAUTION**" are used to stress important safety information. The word:

**⚠ DANGER** indicates an imminently hazardous situation which, if not avoided, is likely to result in death or serious injury.

**⚠ WARNING** indicates a potentially hazardous situation which, if not avoided, could result in death or serious injury.

**⚠ CAUTION** indicates a potentially hazardous situation which, if not avoided, may result in injury or property damage.

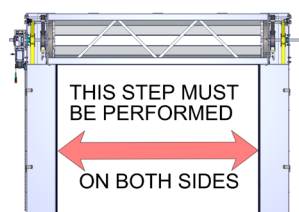
The word **NOTE** is used to indicate important steps to be followed or important considerations.

1. With the door in the fully closed position, remove the bolts that hold the guide covers in place. Set bolts aside in a safe place and open guides, as shown in **FIG 1.0**.

**NOTE:** Guide covers swing open on hinges, or can be lifted off hinge pins and removed to ease installation.



**FIG 1.0**



2. Pull the red handle down to disengage the motor. Using the chain hoist, raise the door approximately 6" off the Floor, as shown in **FIG 2.0**.

## ⚠ WARNING

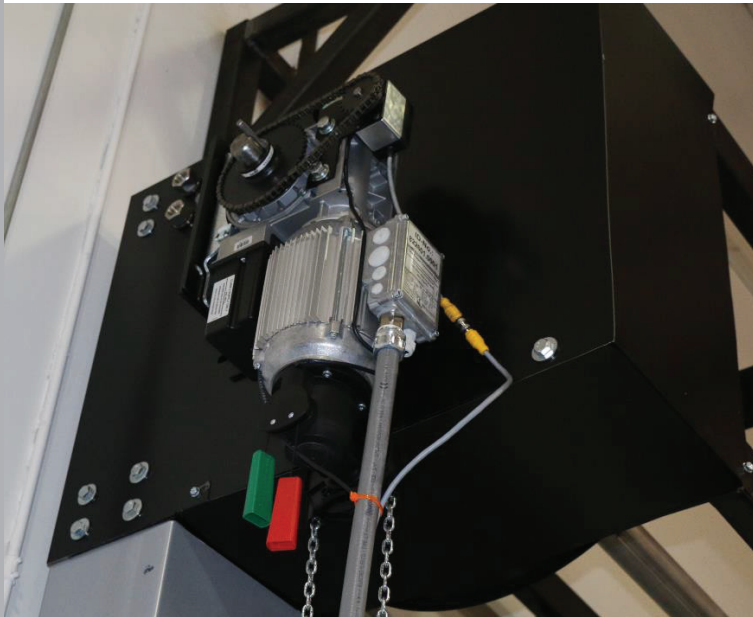
LINE POWER should **DE-ENERGIZED** at this time. In the following steps electrical components will be physically removed and new components mounted. Ensure that all incoming power supplies have been de-energized prior to beginning work on attachment of electrical control systems. Use proper Lock Out/Tag Out procedures. Do NOT connect components to electrical supply until directed to do so. Failure to follow this warning could result in serious injury or death as well as equipment damage.

3. Install ratchet straps on each side, as shown in **FIG 3.0**.

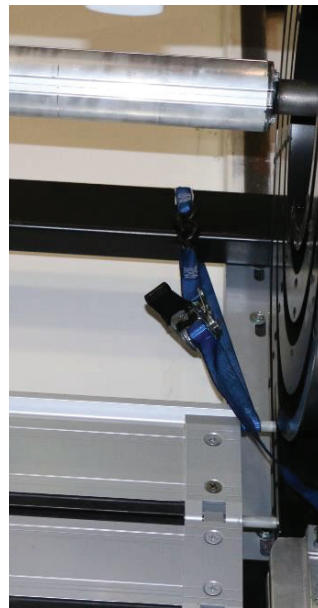
**NOTE:** Each ratchet strap are connecting the back of the header tube to the top roller shaft.

## ⚠ WARNING

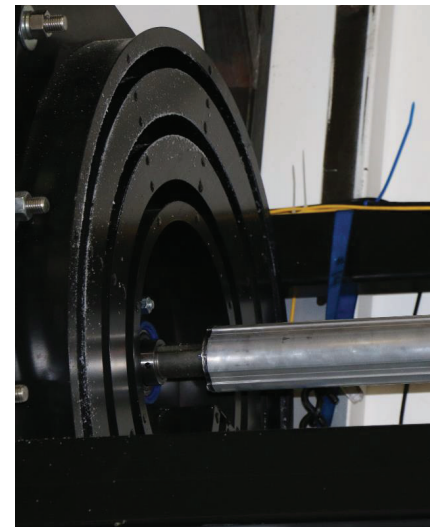
Use ratchet straps with an appropriate load rating for the job. Improper ratchet use could result in Death or Serious Injury.



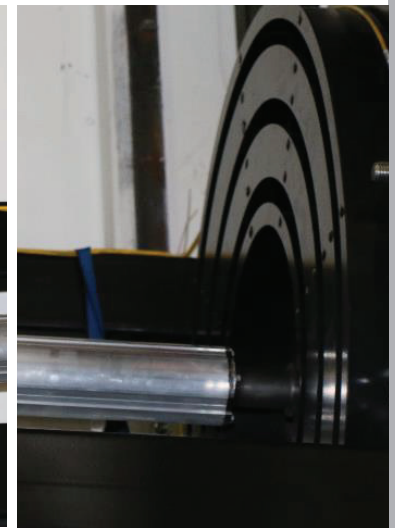
**FIG 2.0**



**FIG 3.0**



**CORRECT**, Strap under cables.

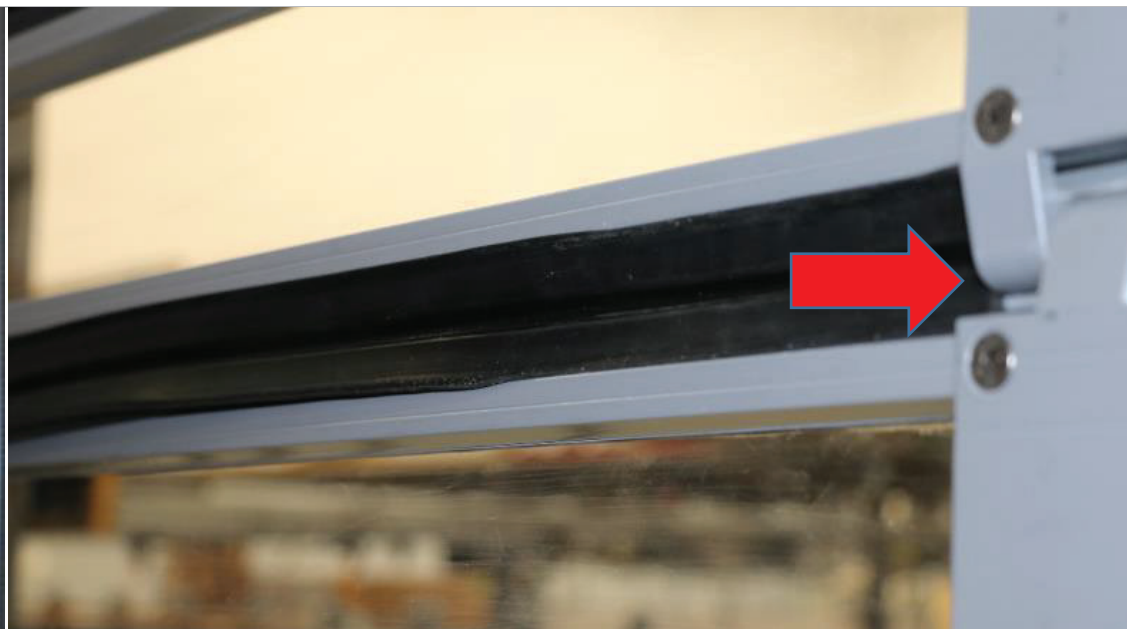
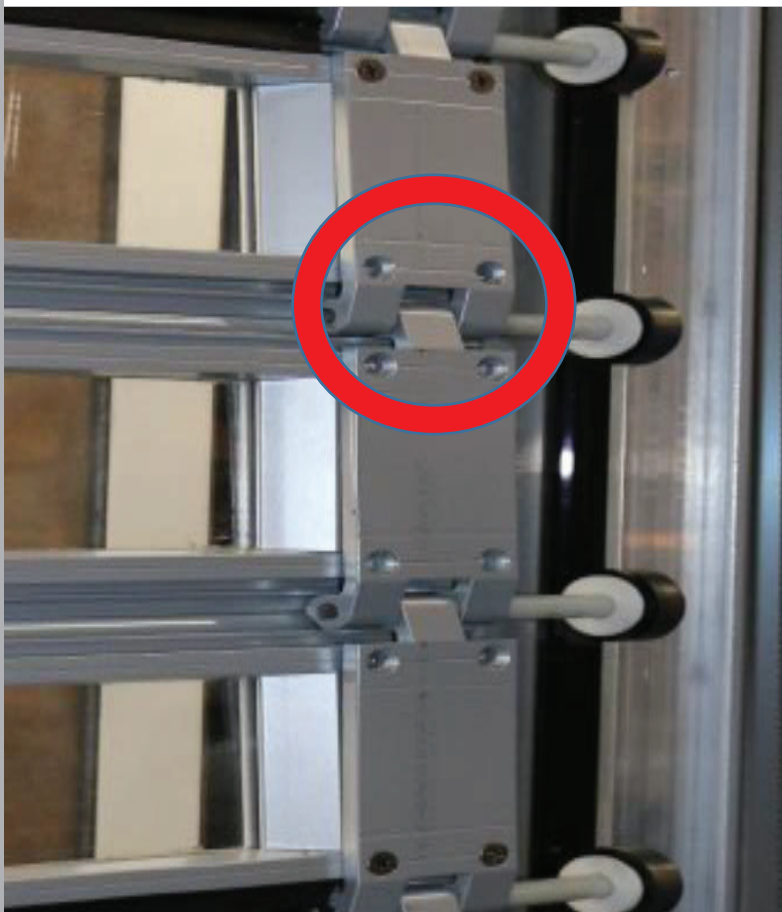


**INCORRECT**, Strap on top and pinching cables (potentially cable damaging)

## ⚠ CAUTION

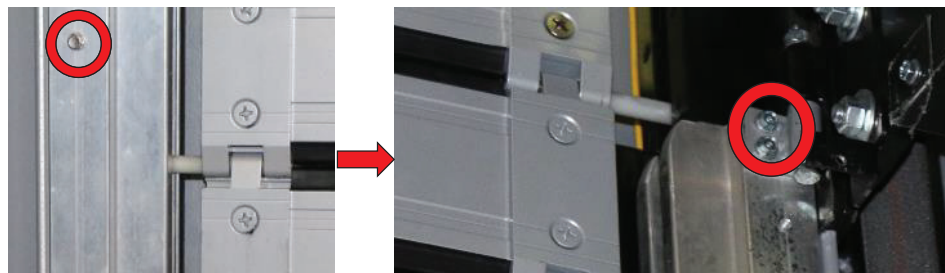
Improper ratchet strap use can lead to damage of the wiring.

4. For the slat getting replaced, remove the screws from the hinge. Two above the roller and two below. Set screws aside in a safe place. Starting at one end, pull out the seal, as shown in **FIG 4.0**.

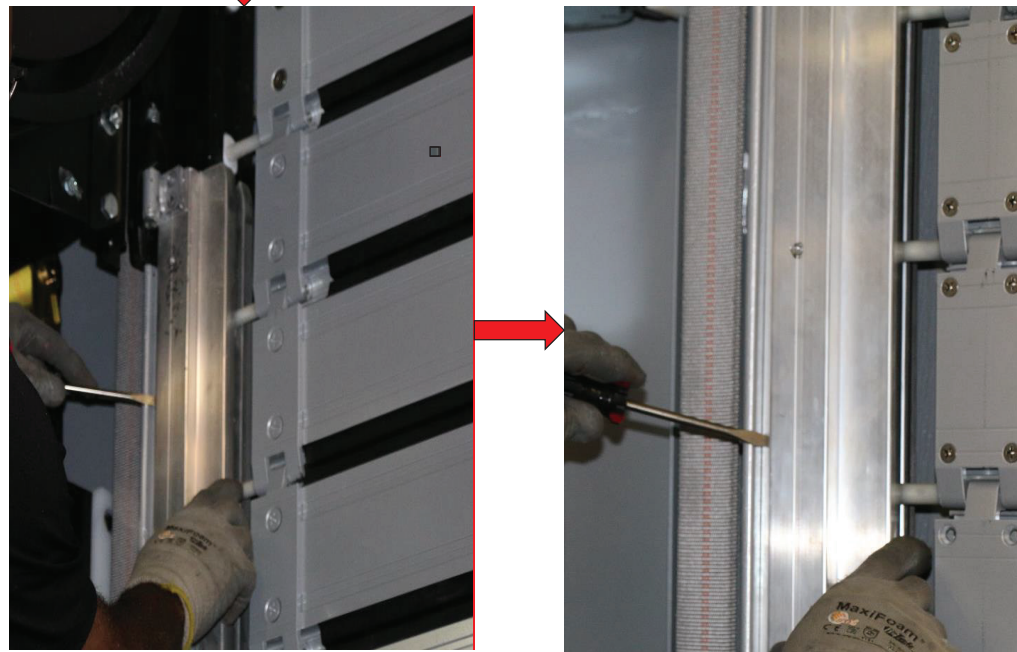


**FIG 4.0**

5. Starting on the left hand side of the door, remove the bolts from the aluminum track and remove the exterior guide from the guides. Set bolts and tracks aside in a safe place. Starting at the top portion of the guide and using a flat screwdriver, gently pry the exterior guide from the angle, as shown in **FIG 5.0**. Repeat the same process for right hand side. Pull curtain out of the guides to get access side of slats, as shown in **FIG 5.1**.



**FIG 5.0**



**CAUTION**

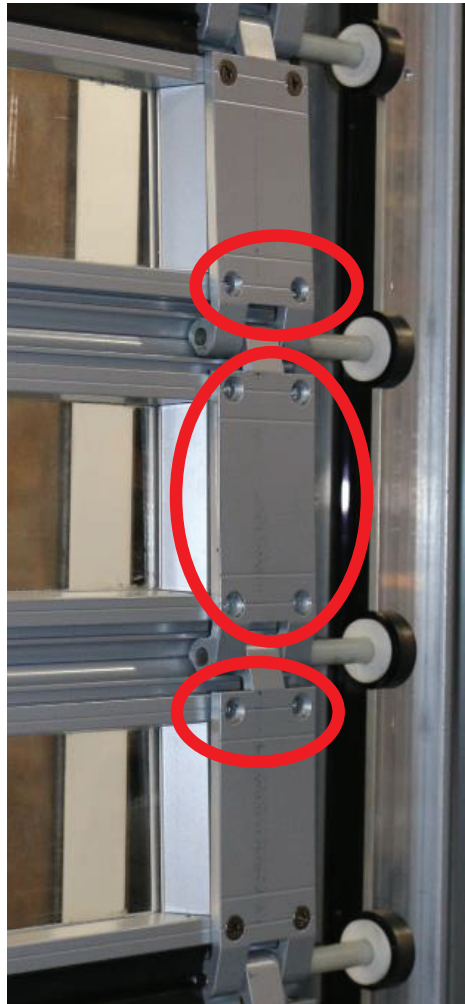
The curtain and guide can pinch fingers. Use two people to maintain control of the curtain during replacement.



**FIG 5.1**

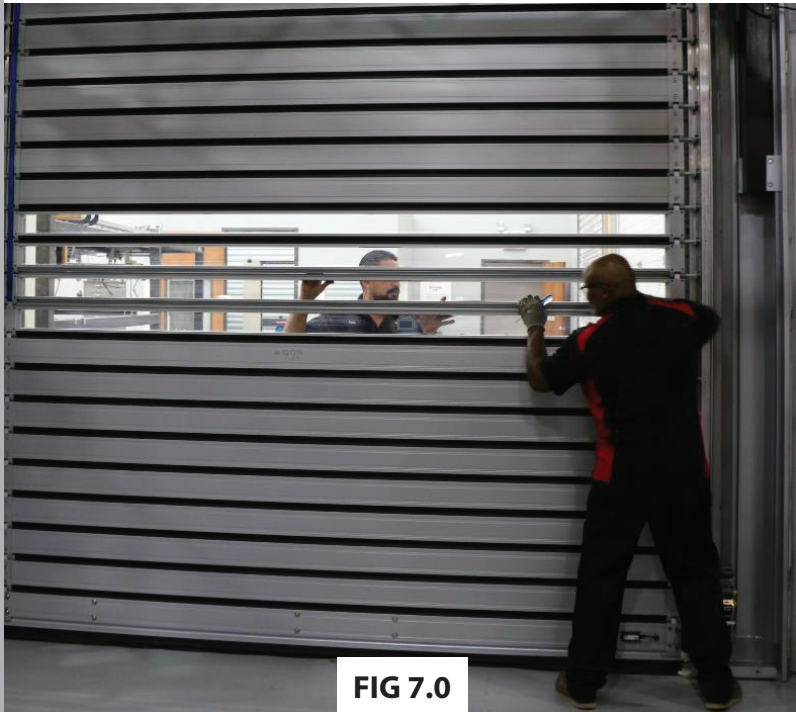
**6.** For the slat getting replaced, remove the screws from bottom of slat above the slat getting replaced. Remove the screws from the top of the slat and below the slat being replaced, as shown in **FIG 6.0**.

**NOTE:** For a door wider than 15', the screws from center hinges in similar locations will need to be removed.



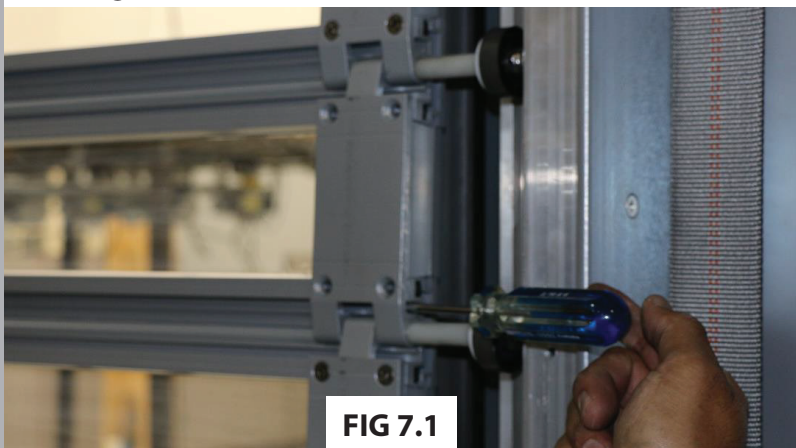
**FIG 6.0**

7. With one person on each side of the door, remove the slat outward, as shown in **FIG 7.0** and **FIG 7.1**. If there's **CORRECT** tension on the ratchet straps, the door stays straight. This makes putting in a new slat easier, as shown in **FIG 7.2**. If there's **INCORRECT** or not enough tension on ratchet straps, the door will droop. This makes putting in a new slat much more difficult, as shown in **FIG 7.3**.



**FIG 7.0**

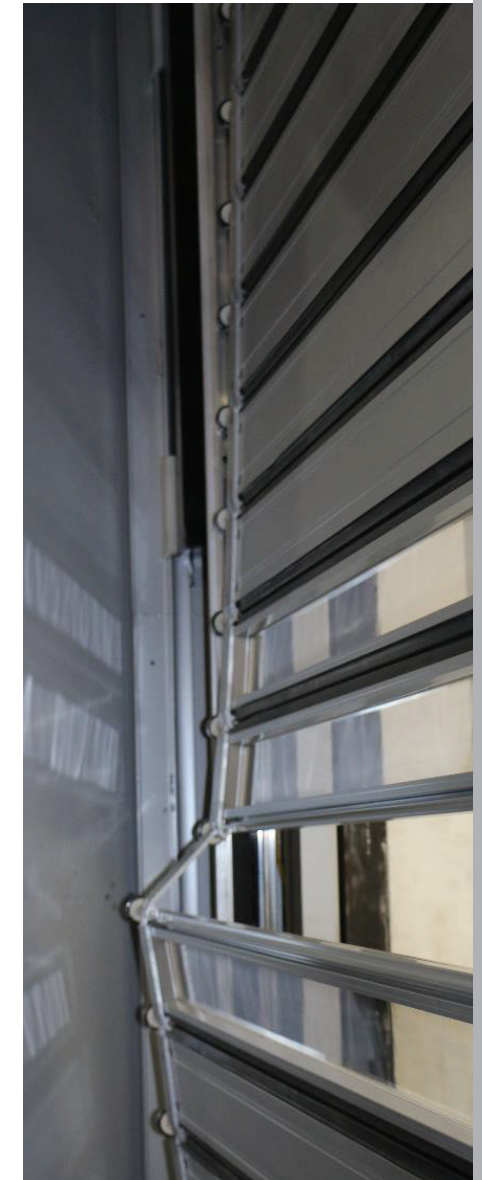
**NOTE:** Use screwdriver to gently pry apart the slat from the hinge, as shown in **FIG 7.1**.



**FIG 7.1**



**FIG 7.2**



**FIG 7.3**

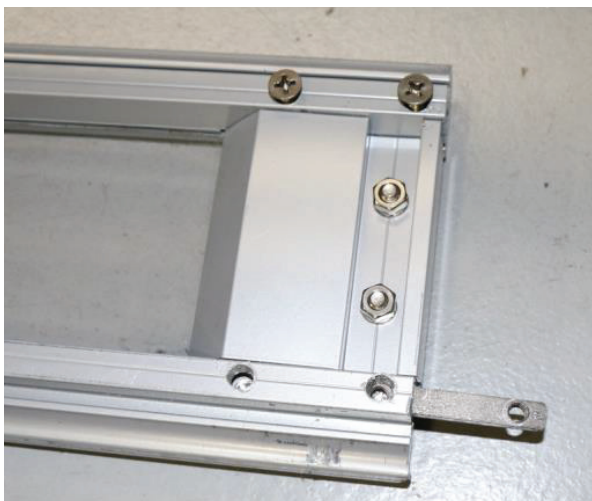
8. To prepare the new slat for installation, remove the hinge screw backers.

**FOR VISION SLAT BACKER:** Illustration shown installed correctly. One piece for the top rail and one for the bottom rail, as shown in **FIG 8.0**. Slide the screw backer out, as shown in **FIG 8.1** and **FIG 8.2**.

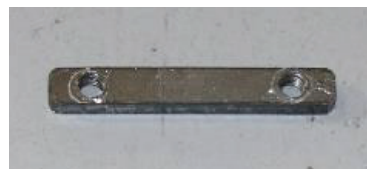
**FOR SOLID SLAT BACKER:** Illustration shown installed correctly. One piece for both screws, as shown in **FIG 8.3**.



**FIG 8.0**



**FIG 8.1**



**FIG 8.2**



**FIG 8.3**



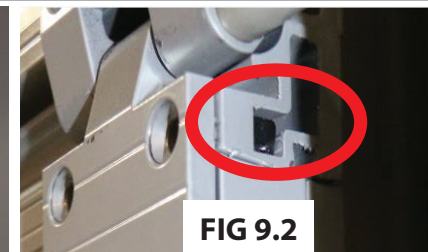
9. Insert the new slat along the bottom edge of the slat and rotate the slat into position behind the hinge. Push the new slat flush with end hinges. Make sure the slats above and below the new slat getting replaced is completely vertical, so that the new slat can easily get inserted into position, as shown in **FIG 9.0**. Make sure both the hinges and the slats are vertically aligned and flushed on the right hand side, as shown in **FIG 9.1**.

**HINGE SCREW BACKER PLACEMENT CORRECT:** Screw Backer in position and the holes line up with hinge holes, as shown in **FIG 9.2**.

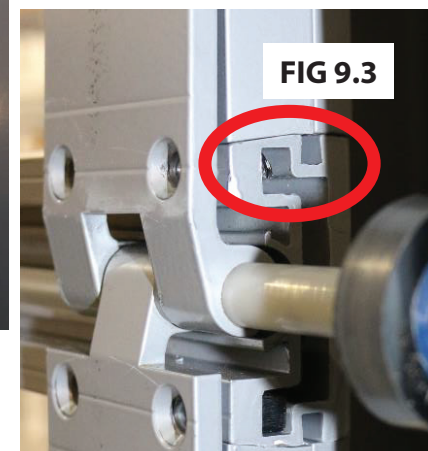
**HINGE SCREW BACKER PLACEMENT INCORRECT:** If you forget to remove the screw backers before installing the new slat back into position, the retainers can get "lost" inside the slat and the slat would have to be removed in order to slide them out, as shown in **FIG 9.3**.



**FIG 9.1**



**FIG 9.2**



**FIG 9.3**



**FIG 9.0**

**10.** Install one screw in the end hinge on each side of the new slat. Secure the new slat by installing the rest of the screws. Install the screws in current slats above and below the new slat, as shown in **FIG 10.0**.

**NOTE:** If the door has center hinges, install those screws.

**NOTE:** Use a screwdriver, rather than a drill or impact driver, as well as use red locktite on the threads of each screw.



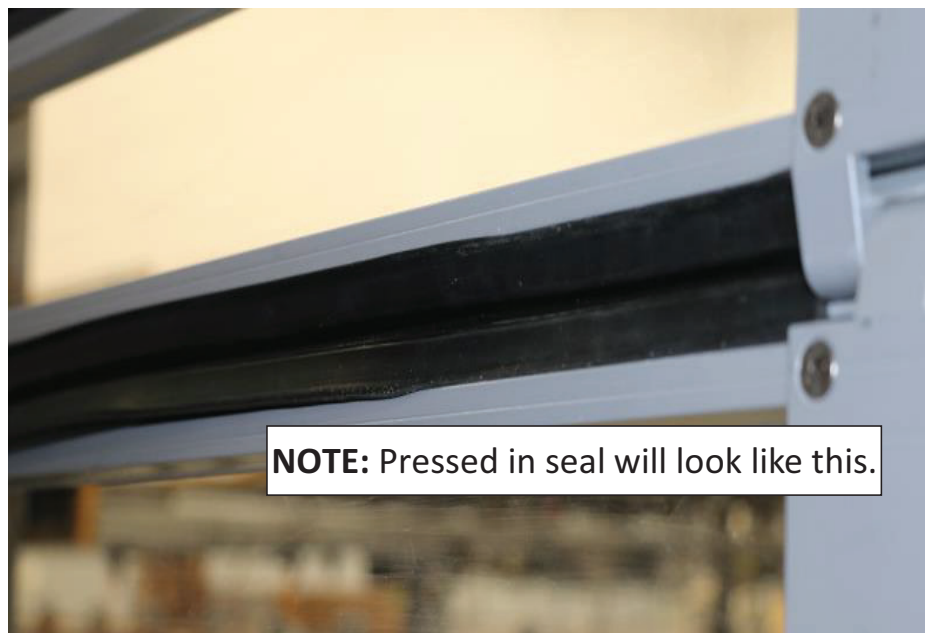
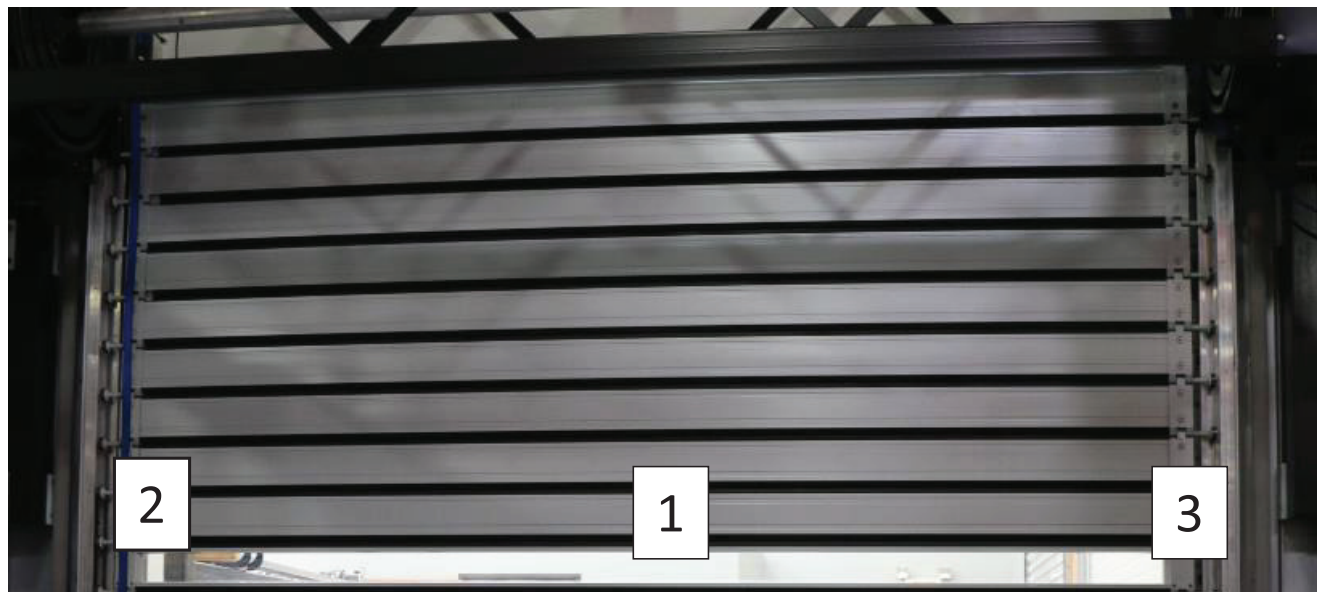
**FIG 10.0**

**11.** Install the seal by pressing in at the middle portion of the door, then from each ends (2,3). Push from one end to the other (3 to 1, then 2 to 1), as shown in **FIG 11.0**.

**NOTE:** To make it easier to press in the seal, wipe or spray soapy water on the front and back surface of the seal. This will make it easier to push in, as well as slide your hand along and press the seal into the groove.

RE-ENERGIZED the power to the power supply. Cycle door a few times to ensure everything is operating as it should.

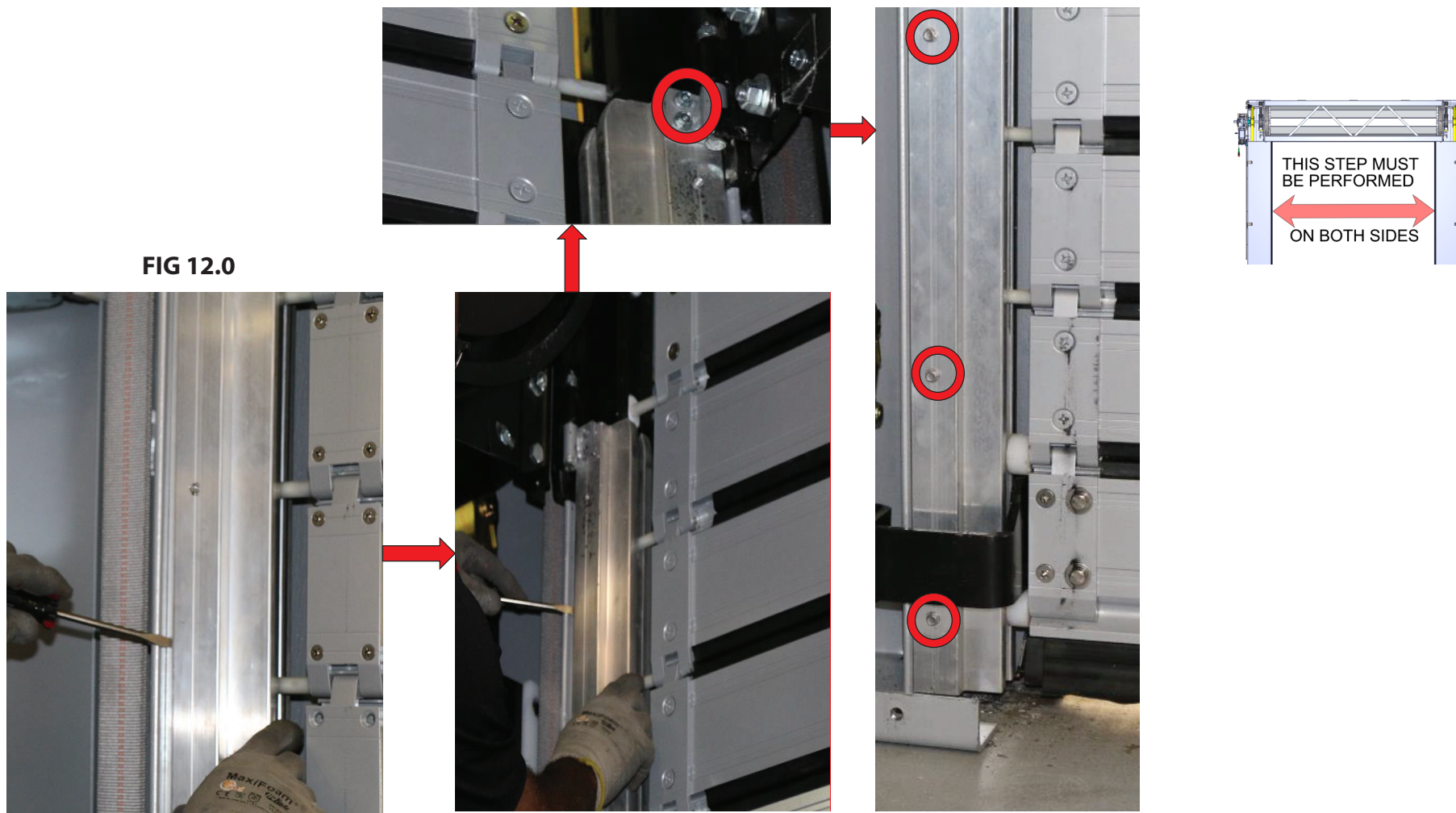
Close or re-attach the guide covers, as shown in **FIG 1.0**.



**FIG 11.0**

**12.** Push curtain back into the guides. Using a flat screwdriver and starting at the bottom portion of the exterior guide, gently push the exterior guide back into the angle. Secure the exterior guide to the angle with the hardware previously removed, as shown in **FIG 12.0**. Repeat the same process for right hand side.

**FIG 12.0**



**13.** After re-installing the exterior guide, manually run the door up and down to ensure smooth movement (visual and feel), as shown in **FIG 13.0**.

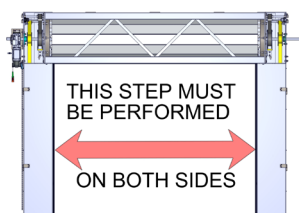
**⚠ CAUTION**

Aside from the person operating the door with the chain hoist, stay clear of the door area when operating the door to ensure no injuries.



**FIG 13.0**

14. Close or re-attach the guide covers. Install the bolts to secure the guide covers in place, as shown in **FIG 14.0**.



**FIG 14.0**

**14.** Pull the green handle down to engage the motor is engaged, as shown in **FIG 14.0**.



**FIG 14.0**